

Installation Instructions

Ratchet Threading and Use

Threading Instructions

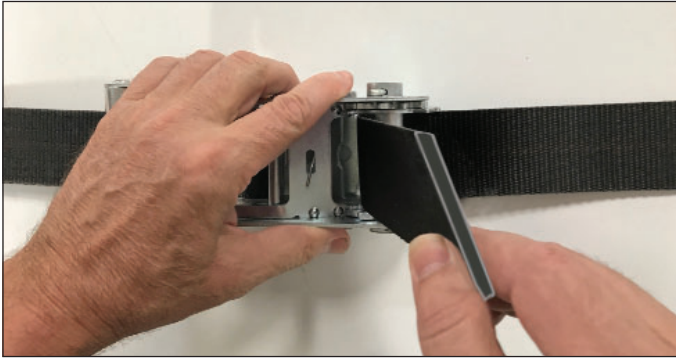

1. Thread web thru slot in center rotating spool of closed ratchet.



2. Pull webbing thru to take up most of the slack, some slack is required for proper installation.

Note: Proper threading/tightening of ratchet webs is critical. Insure all straps are properly threaded/tightened and free of damage or wear prior to each use.

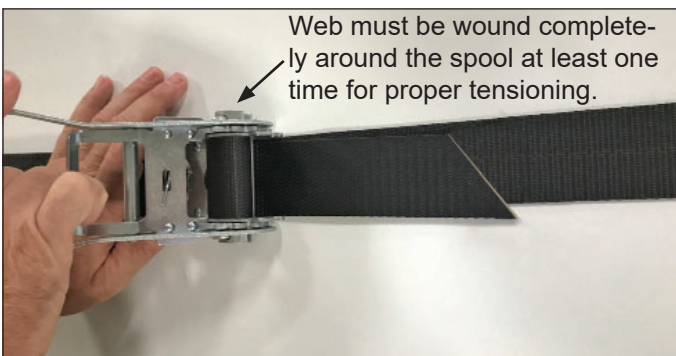

3. Start ratcheting (raising and lowering handle). Webbing will wind itself and be locked in place so that further ratcheting will rapidly increase tension in strap.

Release Instructions

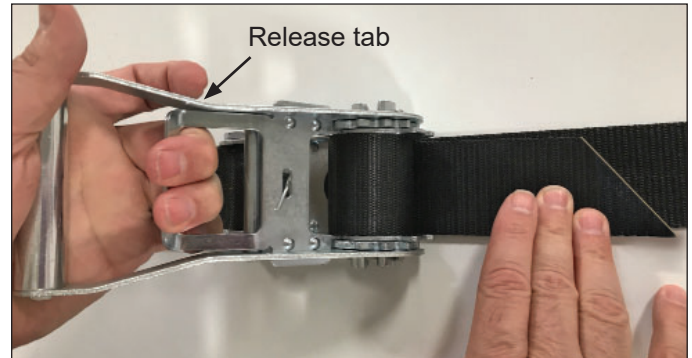

1. To release webbing, pull and hold release tab on top assembly to override ratcheting function and open ratchet until both assemblies are in-line and top assembly clicks into place.

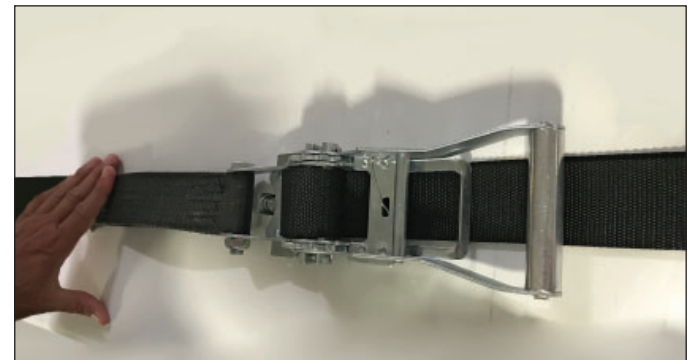

2. Ratchet shown in open position.

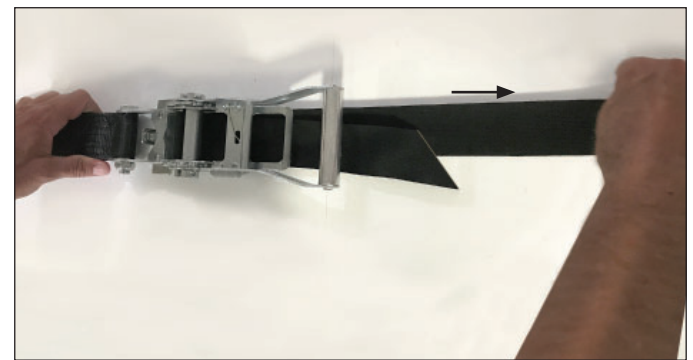

3. Grab webbing from non-fixed side and pull to release webbing.

See over for web in pocket instructions →

Wrap Around Web in Pocket/ Cap Style Spa Cover Instructions

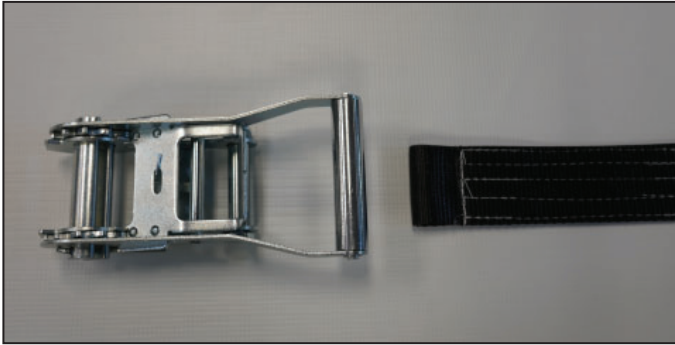

1. Ratchet shown in a closed position with nut and bolt secured to the ratchet body.

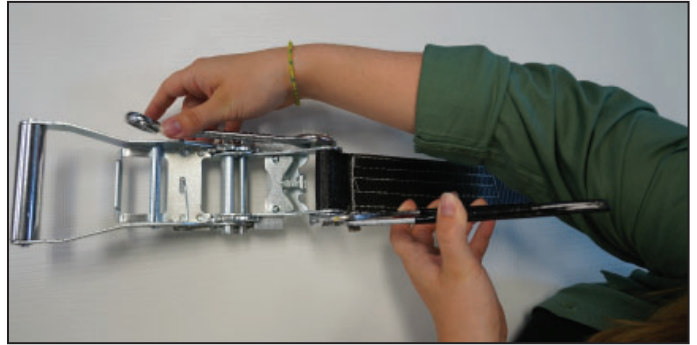

3. Position web loop in line with bolt holes on the ratchet body. Insert bolt through web and fasten with nyloc nut.

Note: Web placement may or may not be secured, depending on the application of the cover being used.

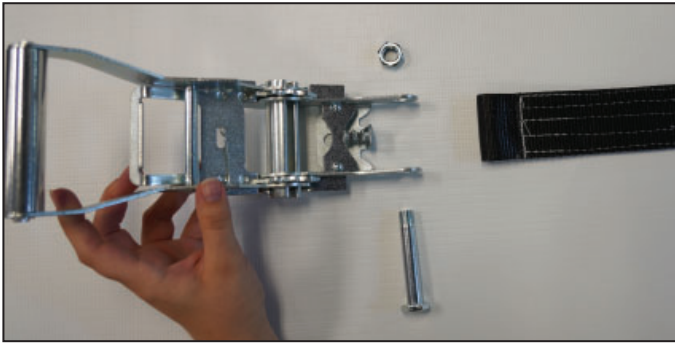

2. Move ratchet to an open position (Reference step one in Release Instructions). Remove nut and bolt.

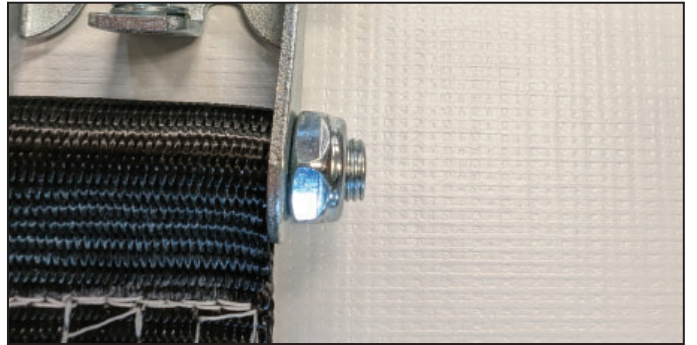

4. Ensure bolt is tightened so that it is at least three thread lengths past the nylon ring on the nyloc nut.



7701 Highway 41 N
Evansville, IN 47725
Phone: 812-867-2421
Fax: 812-867-1429
1-800-255-5552
email: custdiv@anchorinc.com
www.anchorinc.com