

PLAN

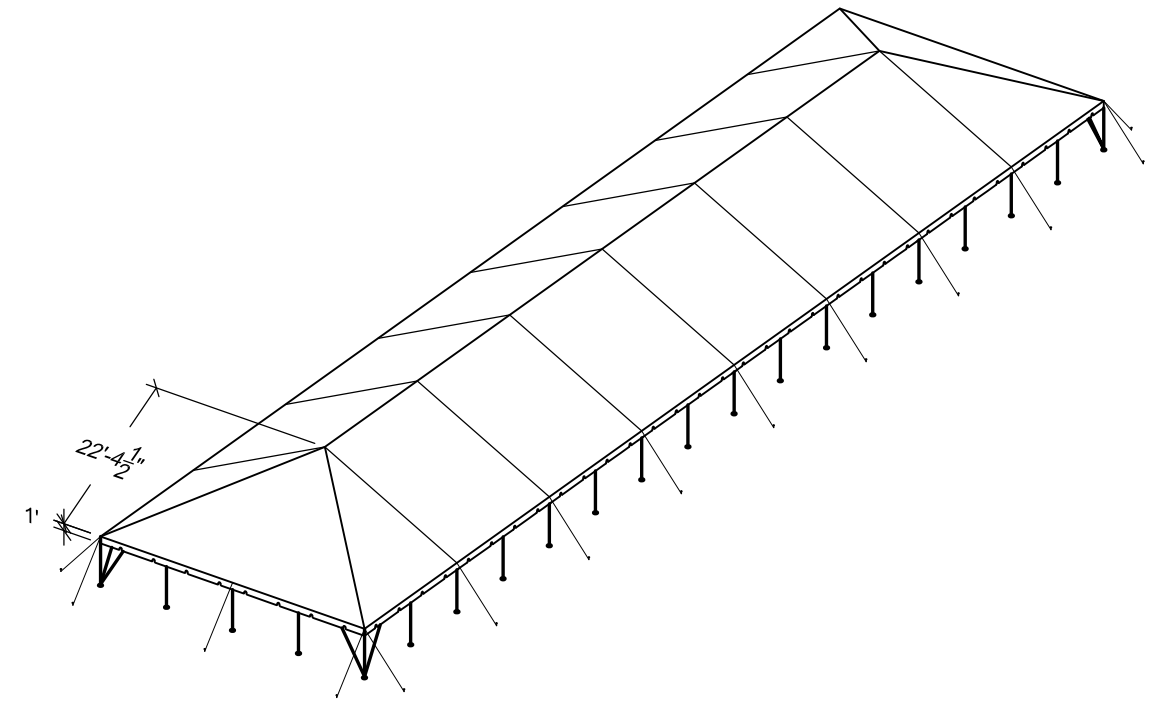

WITH FABRIC TOP

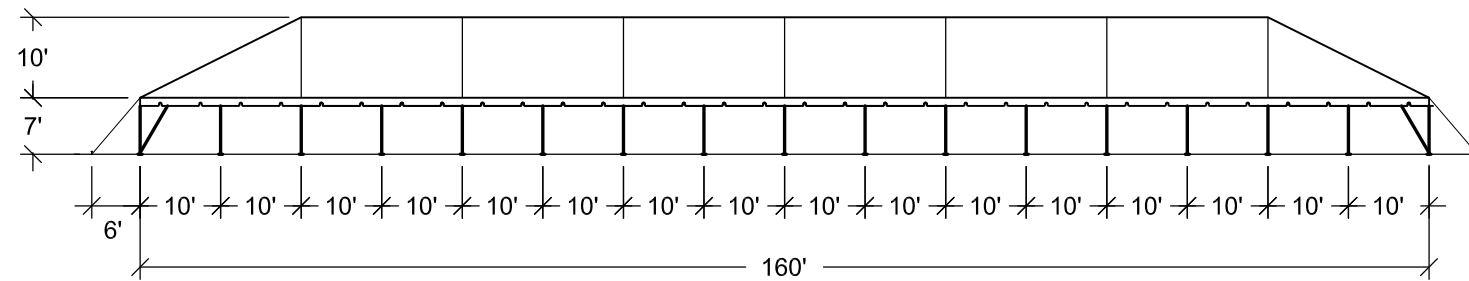

SIDE ELEVATION

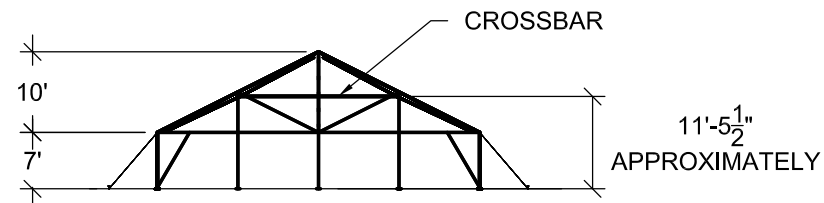

END ELEVATION

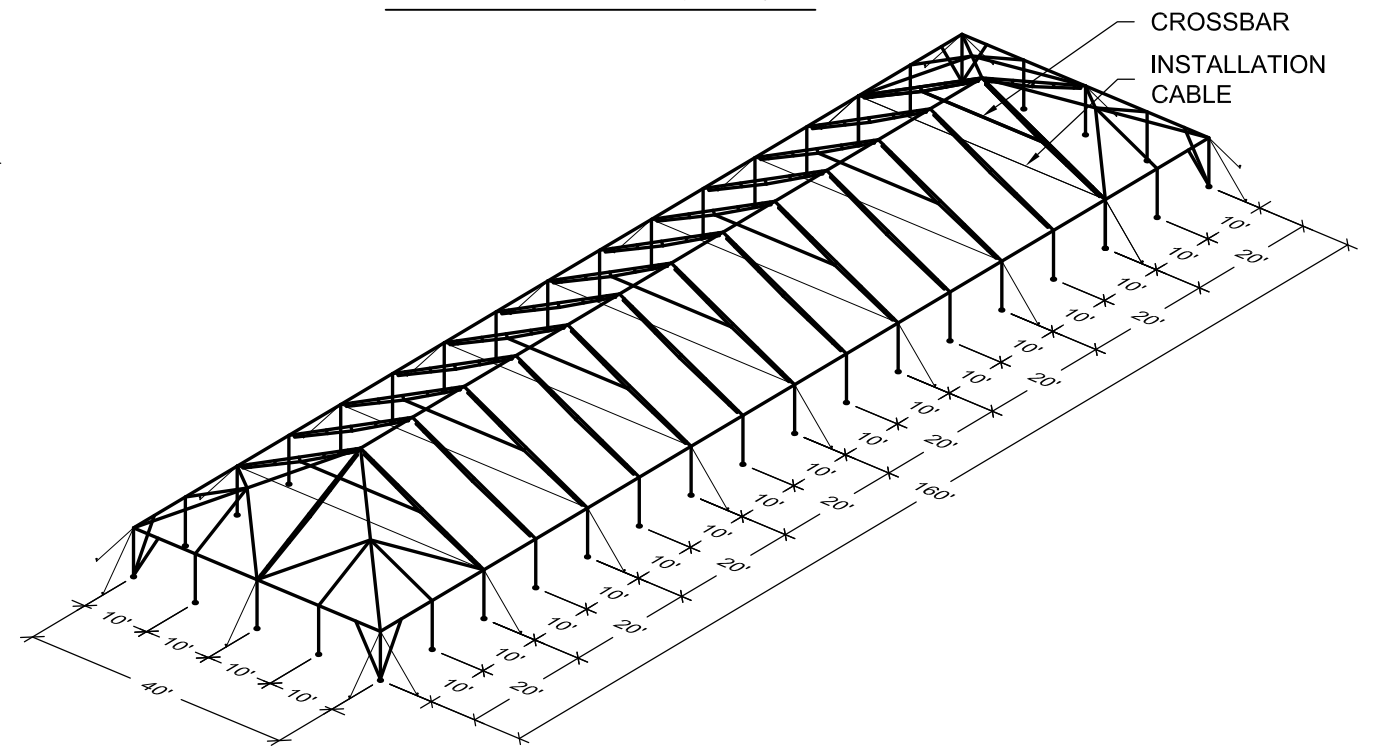

ISOMETRIC

NOTES:

- SEE THE I.F.A.I. STAKING GUIDE ON THE .IF.A.I. WEBSITE (WWW.IFAI.COM) FOR SOIL IDENTIFICATION & PULL-OUT CAPACITY OF STAKES.

Caution:

Staking or anchoring is the responsibility of the installer. Soil conditions will dictate the number of stakes or anchors required. **Do not use this drawing to determine staking requirements.** Contact Anchor for Engineering loading data that can be used in conjunction with IFAI methodologies to determine site specific anchoring requirements.

REVISIONS

EC/PR NO.	DATE	BY

ANCHOR INDUSTRIES INC.

**INDESTRUCTO RENTAL
40' x 160' x 7' FIESTA PLUS II FRAME TENT**

DRAWN BY: DMK	CHECKED BY:	DRAWING NO.
APPROVED BY:	EC/PR NO.	DATE: 02/09/2017

17-149